

BREMBO

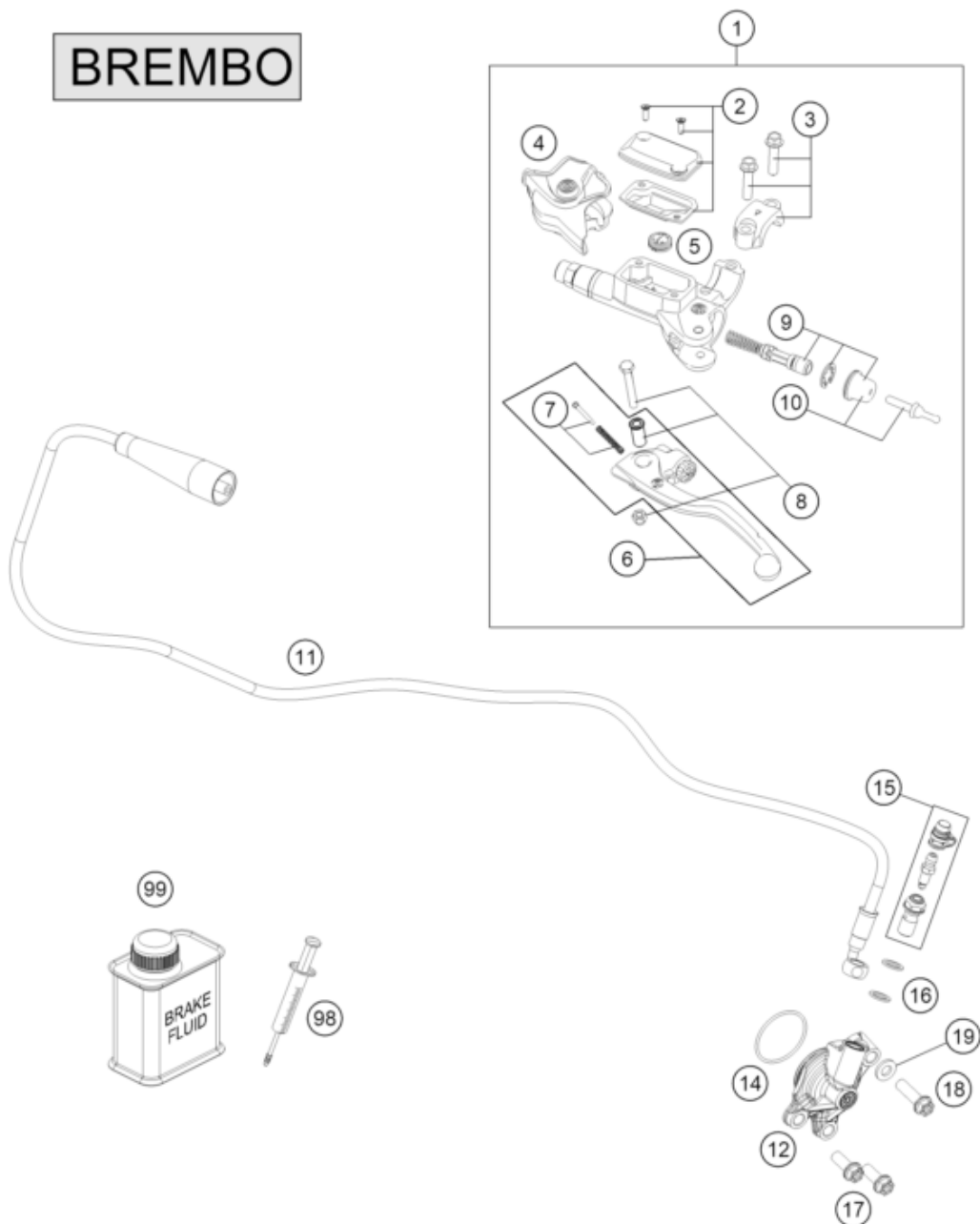

Pos	Part Number	Description	Additional Text	Quantity
1	54802030144	MASTER CYLINDER CPL.		1.00
2	5480200310030	COVER HYD. CLUTCH CPL. 2014		1.00
3	54802005100	CLAMP CPL. 06		1.00
4	54802037000	PROTECTION CAP 06		1.00
5	54802051000	VALVE		1.00
6	54802031000	Clutch lever compl. BREMBO 06		1.00
7	54802052000	BOLT KPL.		1.00
8	54802038100	Lever screw compl. 06		1.00
9	54802032000	REP. KIT PISTON 06		1.00
10	54802046000	Push rod compl.		1.00
11	79232063000	CLUTCH PIPE		1.00
12	79232061044	OUTPUT CYLINDER CPL.		1.00
14	0770300015	O-ring 30x1.5 NBR 70		1.00
15	79032064000	BLEEDER SCREW CPL.		1.00
16	0603082121	SEAL RING CU DIN7603- 8X12X1		2.00

17	0025060166	HH collar screw M6x16 TX30		2.00
18	0025060256	HH collar screw M6x25 TX30		1.00
19	0125060003	WASHER DIN0125-A 6,4		1.00
98	50329050000	VENT INJEKTION HYDR. CLUTCH		0.00
99	00062030000	Brake fluid DOT5.1 0,25L		0.00