

BREMBO

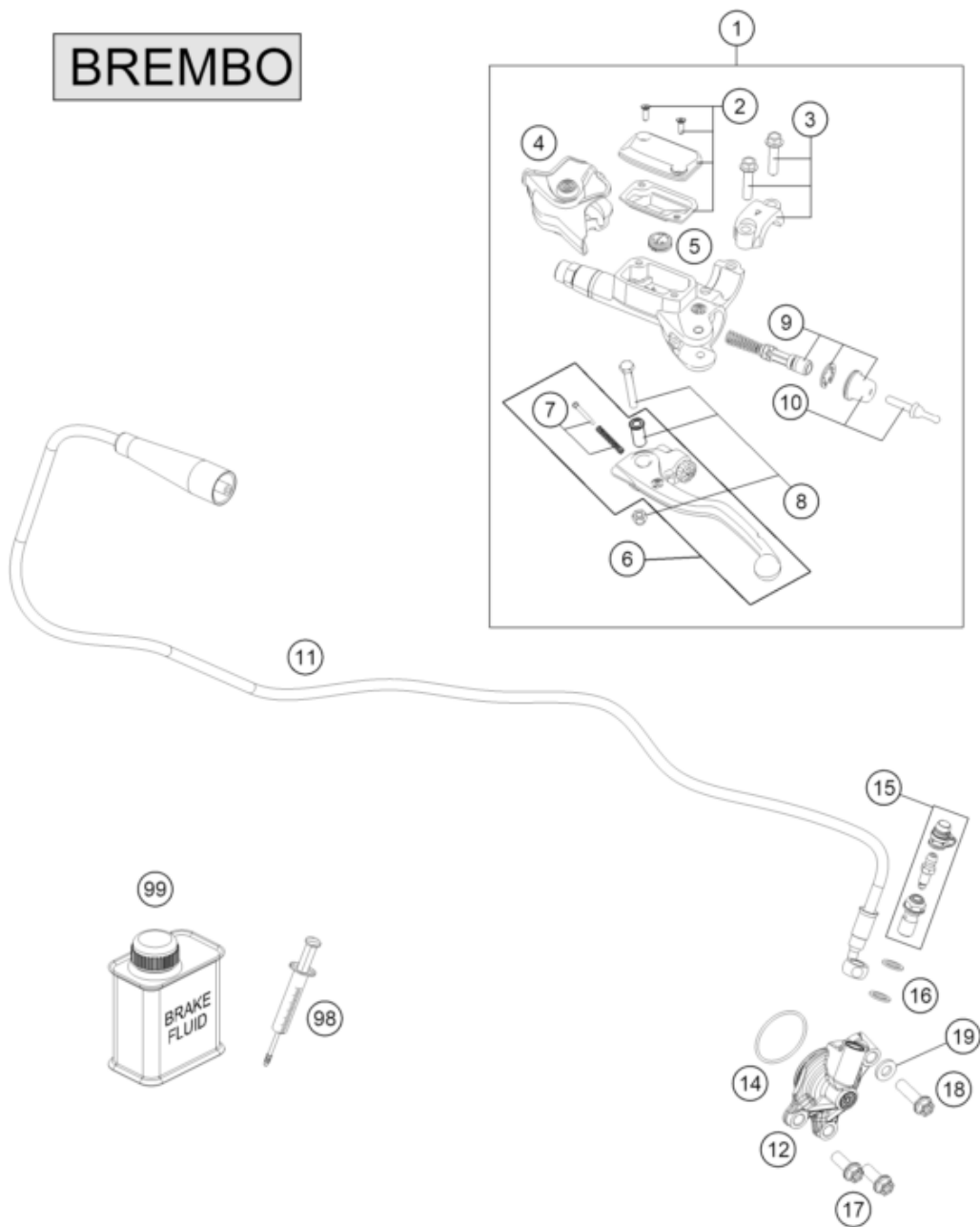

| Pos | Part Number | Description | Additional Text | Quantity |
|-----|---------------|-------------------------------|-----------------|----------|
| 1 | 54802030144 | MASTER CYLINDER CPL. | | 1.00 |
| 2 | 5480200310030 | COVER HYD. CLUTCH CPL. 2014 | | 1.00 |
| 3 | 54802005100 | CLAMP CPL. 06 | | 1.00 |
| 4 | 54802037000 | PROTECTION CAP 06 | | 1.00 |
| 5 | 54802051000 | VALVE | | 1.00 |
| 6 | 54802031000 | Clutch lever compl. BREMBO 06 | | 1.00 |
| 7 | 54802052000 | BOLT KPL. | | 1.00 |
| 8 | 54802038100 | Lever screw compl. 06 | | 1.00 |
| 9 | 54802032000 | REP. KIT PISTON 06 | | 1.00 |
| 10 | 54802046000 | Push rod compl. | | 1.00 |
| 11 | 79232063000 | CLUTCH PIPE | | 1.00 |
| 12 | 79232061044 | OUTPUT CYLINDER CPL. | | 1.00 |
| 14 | 0770300015 | O-ring 30x1.5 NBR 70 | | 1.00 |
| 15 | 79032064000 | BLEEDER SCREW CPL. | | 1.00 |
| 16 | 0603082121 | SEAL RING CU DIN7603- 8X12X1 | | 2.00 |

| | | | | |
|----|-------------|-----------------------------|--|------|
| 17 | 0025060166 | HH collar screw M6x16 TX30 | | 2.00 |
| 18 | 0025060256 | HH collar screw M6x25 TX30 | | 1.00 |
| 19 | 0125060003 | WASHER DIN0125-A 6,4 | | 1.00 |
| 98 | 50329050000 | VENT INJEKTION HYDR. CLUTCH | | 0.00 |
| 99 | 00062030000 | Brake fluid DOT5.1 0,25L | | 0.00 |