

ACHTUNG!!!
Pos. 18 und 19 müssen
gemeinsam getauscht werden!

CAUTION!!!
Pos. 18 and 19 have to be
changed together!

ENTHALTEN IM DICHTSATZ MOTOR
INCLUDED IN GASKET SET ENGINE

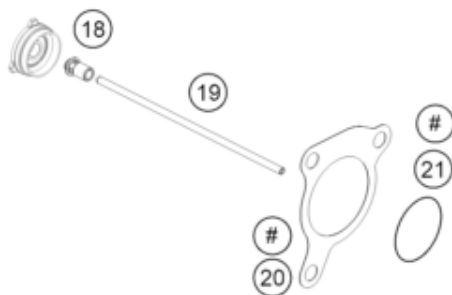

Pos	Part Number	Description	Additional Text	Quantity
1	014580050306	Cyl.screw DIN14580 M5x30		3.00
2	A60632006000	Clutch pressure plate stop		1.00
3	A60632005000	Clutch spring		3.00
4	A60632041000	Spring retainer		3.00
5	0004724517500	Lock ring DIN0472-45x1.75		1.00
6	A60632004044	Clutch pressure plate insert c		1.00
7	A60632003000	Clutch pressure plate		1.00
8	60036073150	hex nut M20x1, H=6mm		1.00
9	0252012103100	Wedge lock washer HLS 20		1.00
10	A60632002000	Inner clutch hub		1.00

11	75032009000	STEPPED WASHER 07		1.00
12	75032007000	HALF-WASHER 07		2.00
13	A60632001044	Outer clutch hub compl.		1.00
14	56532095000	NEEDLE BEARING K26X30X22ZW.KSE		1.00
15	75032017000	WASHER 26X40X2 07		1.00
18	75032055100	PRESSURE BOLT 08		1.00
19	75032054200	PUSH ROD 08		1.00
20	59032065100	GASKET F. OUTPUT CYLINDER		1.00
21	0770300015	O-ring 30x1.5 NBR 70		1.00
28	75032112000	STEEL DISK 1,5 MM LC4 '07		5.00
29	A60632011000	LINING DISK 2,7MM FCC 02		6.00
30	58632016000	RONDELLA ANTIVIBRAZIONE SET		1.00
31	A60632011010	LINING DISC CUT OUT		1.00
32	75032112100	STEEL DISK 1,5MM NITRIDED		1.00
99	A60632010044	Clutch Disk Kit		1.00