

**BREMBO**

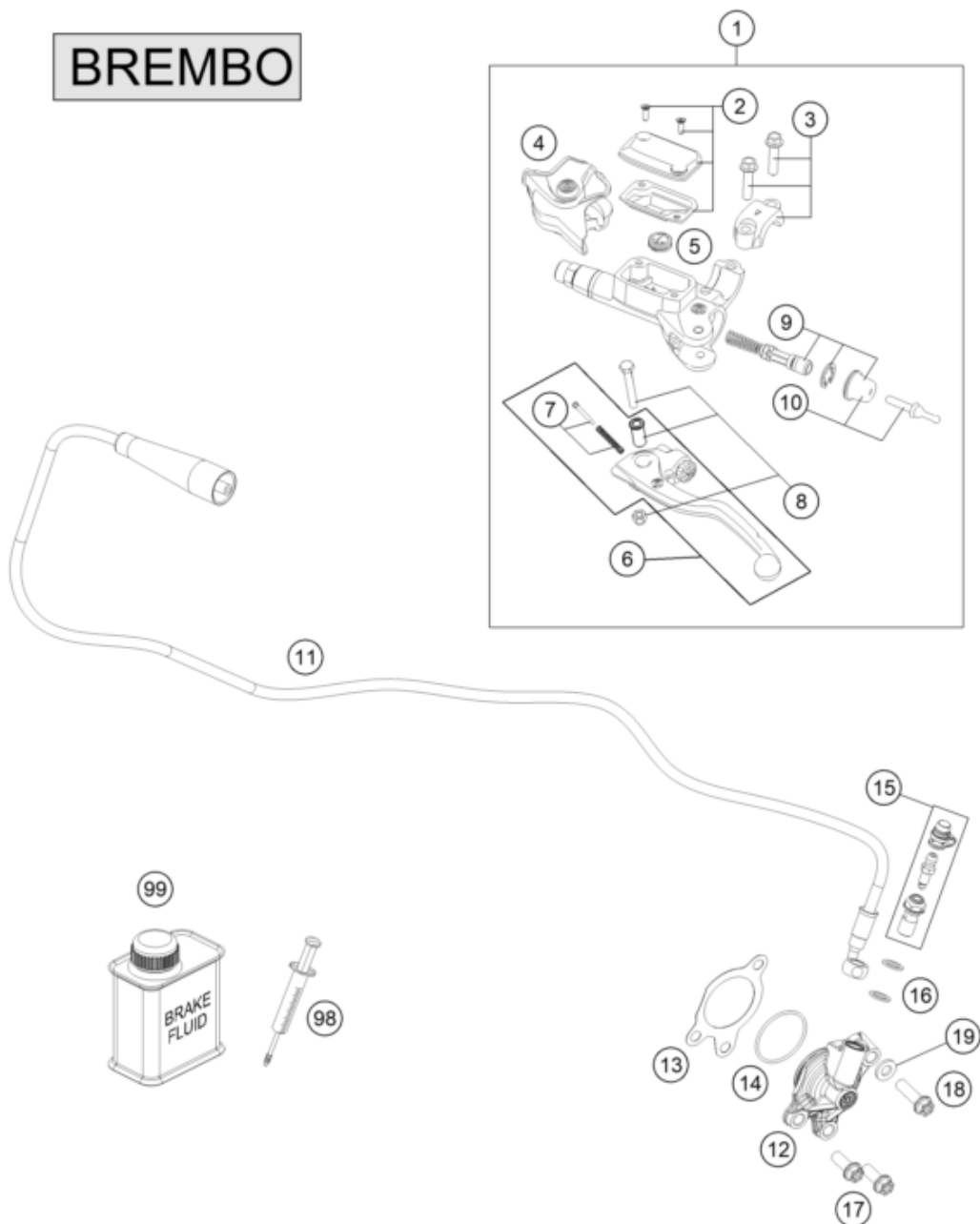

Pos	Part Number	Description	Additional Text	Quantity
1	54802030144	MASTER CYLINDER CPL.		1.00
2	5480200310030	COVER HYD. CLUTCH CPL. 2014		1.00
3	54802005100	CLAMP CPL. 06		1.00
4	54802037000	PROTECTION CAP 06		1.00
5	54802051000	VALVE		1.00
6	54802031000	Clutch lever compl. BREMBO 06		1.00
7	54802052000	BOLT KPL.		1.00
8	54802038100	Lever screw compl. 06		1.00
9	54802032000	REP. KIT PISTON 06		1.00
10	54802046000	Push rod compl.		1.00
11	79232063000	CLUTCH PIPE		1.00
12	79232061044	OUTPUT CYLINDER CPL.		1.00
13	79232065100	Seal, slave cylinder		1.00
14	0770300015	O-ring 30x1.5 NBR 70		1.00
15	79032064000	BLEEDER SCREW CPL.		1.00

16	0603082121	SEAL RING CU DIN7603- 8X12X1		2.00
17	0025060166	HH collar screw M6x16 TX30		2.00
18	0025060256	HH collar screw M6x25 TX30		1.00
19	0125060003	WASHER DIN0125-A 6,4		1.00
98	50329050000	VENT INJEKTION HYDR. CLUTCH		0.00
99	00062030000	Brake fluid DOT5.1 0,25L		0.00