

#1	3	4	11	12
14	19	27	28	
+ WELLENDICHTRINGE / SEAL RING				
1x 0760142460	1x 47030076100			
1x 0760253570	1x 0760324571			
1x 0760385273				
+ LAGER / BEARINGS				
1x 56530123200	1x 79234012010			
1x 0625160040	1x 0625006065			
1x 49030023000	1x 0410002500700			
1x 55430058000	1x 0625062054			
1x 0625623204	1x 0625063022			
1x 0625062038	2x 54632095000			

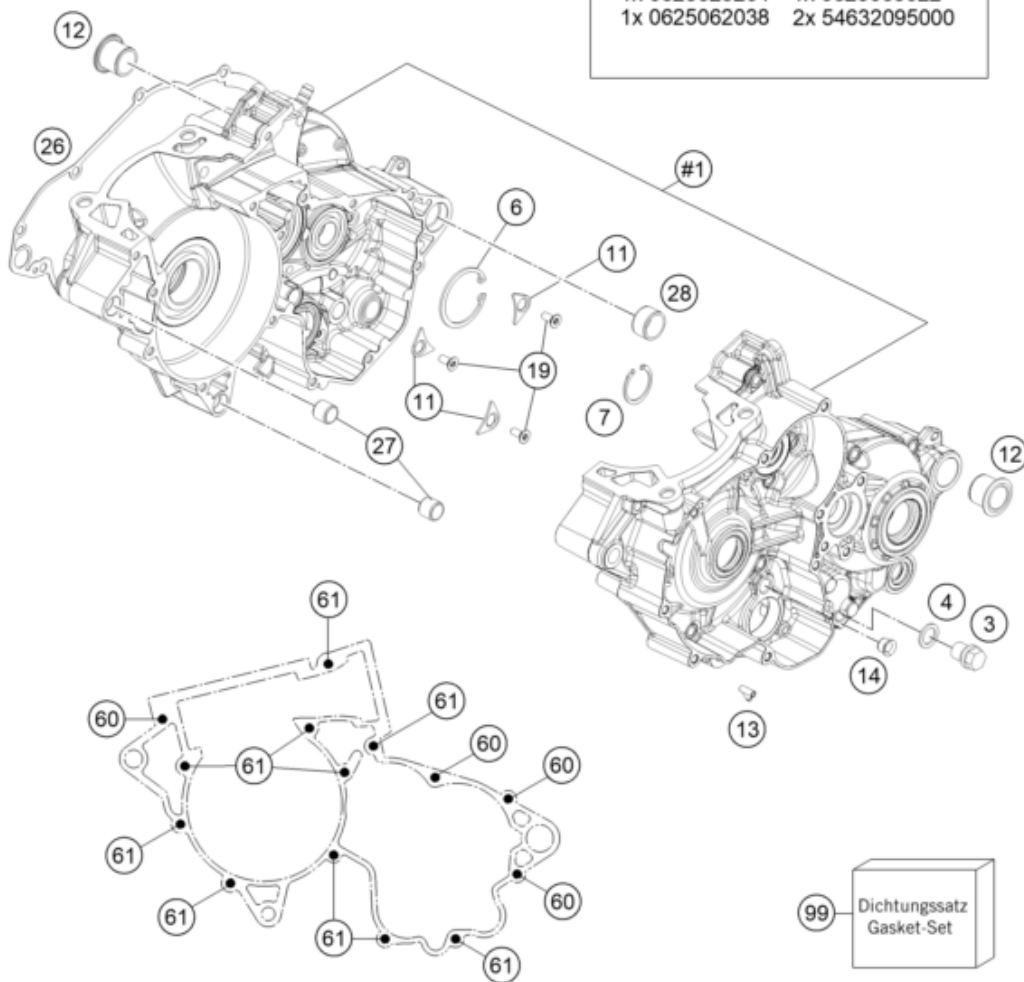

Pos	Part Number	Description	Additional Text	Quantity
1	A44030000044	Engine case cpl.		1.00
3	58030021100	oil drain plug with magnet		1.00
4	58038022000	CU-seal ring DIN7603-12X18X1.5		1.00
6	0472042175	CIRCLIP DIN0472-42X1,75		1.00
7	55430059100	CIRCLIP DIN0472-28X1,2		1.00
11	75030085100	Retaining bracket crankshaft b		3.00
12	79230010000	Housing bush		2.00
13	45130022000	ANGLE PIECE 50CCM LC 2001		1.00
14	55540031000	Collar bushing		1.00
19	0019050121S	INT. TORX FLAT HEAD M5X12 T25		3.00
26	A44030025000	Clutch cover gasket, inner		1.00
27	54630027000	DOWEL BUSHING 13,8X11X12		2.00
28	54830027100	Dowel, 21x12		1.00

60	0025060606	HH collar screw M6x60 TX30		4.00
61	0025060456	HH COLLAR SCREW M6X45 TX30		10.00
99	A44030099000	Gasket kit Engine MX 250/300		0.00