

ACHTUNG !!!
Bei Bestellung von Getrieberädern, Markierung beachten.
CAUTION !!!
When ordering transmission gears, check marking.

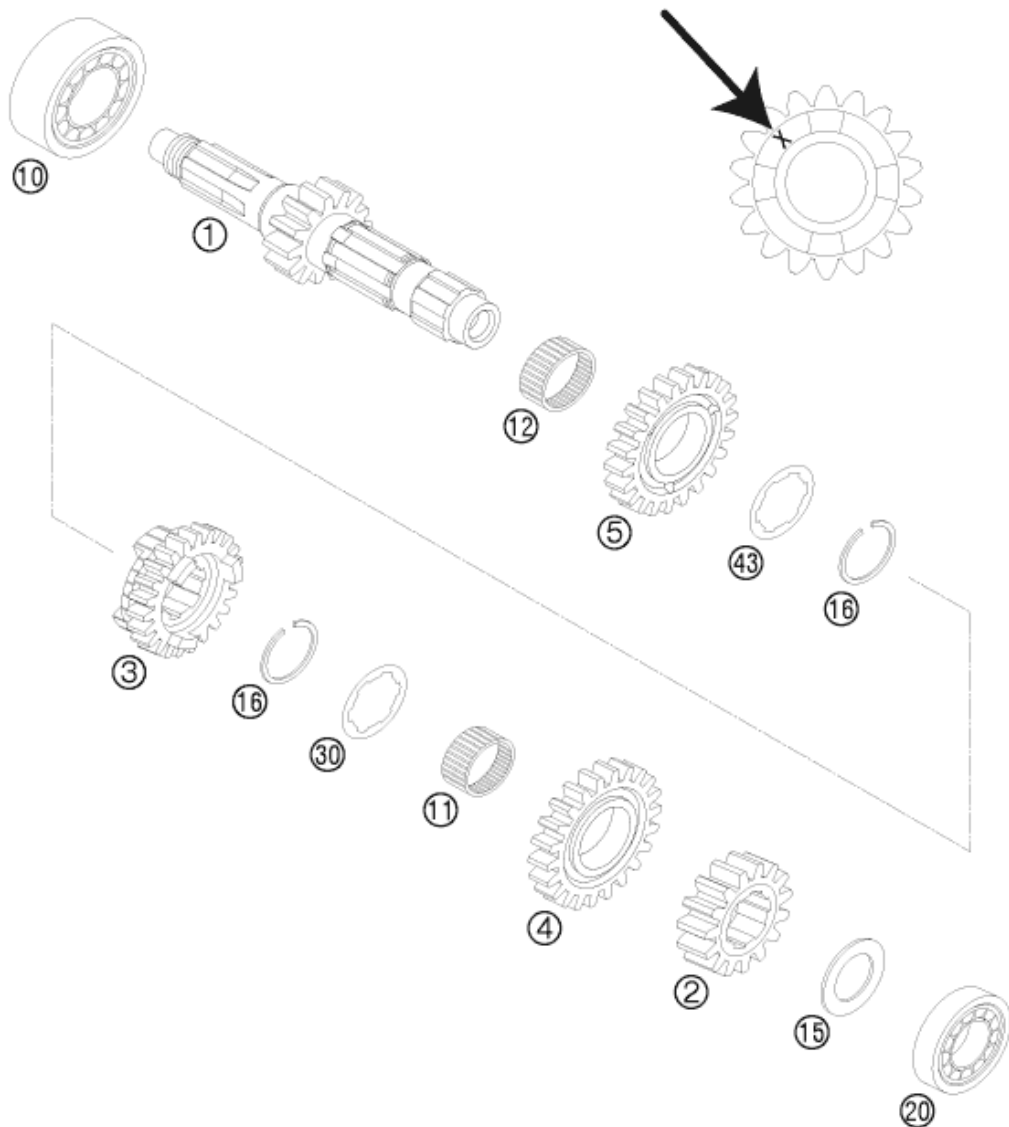

Pos	Part Number	Description	Additional Text	Quantity
1	54833001200	MAIN SHAFT CPL.		1.00
2	54833002200	SOLID GEAR 2.ND 15-Z "2S15"		1.00
3	54833003000	SLIDING GEAR 3RD G. 18-T "3S18"		1.00
4	54833004000	IDLER GEAR 4TH G. 21-T "4S21"		1.00
5	54833005000	IDLER GEAR 5TH G. 22-T "5S22"		1.00
10	0625062054	BALL BEARING 6205 C3 NTN		1.00
11	0405222613	NEEDLE BEAR. K 22X26X13 TN		1.00
12	0405242812	NEEDLE BEAR. K24X28X11,9 DIV.		1.00
15	54633015000	STOP DISK 20,2X33X1,5		1.00
16	77033022000	AXIAL-CIRCLIP 25X1,65		2.00
20	0625160040	GROOVED BALL BEAR. TM 16004 C3		1.00
30	59033030000	STOP DISC 25,2X32X1,5		1.00
43	50333043000	STOP DISC 25,2X32X1		1.00