

ACHTUNG !!!
Bei Bestellung von Getrieberädern, Markierung beachten.

CAUTION !!!
When ordering transmission gears, check marking.

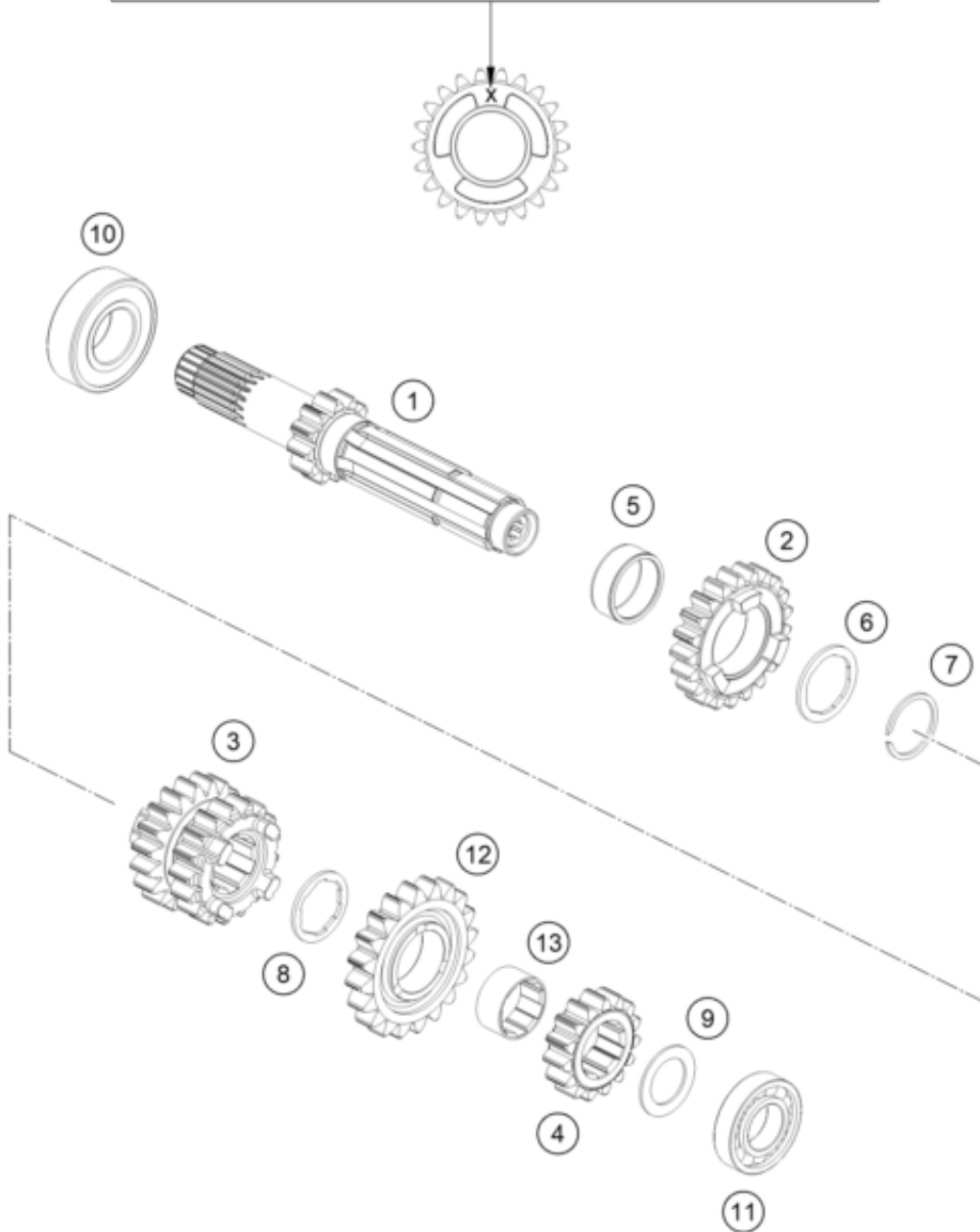

| Pos | Part Number | Description | Additional Text | Quantity |
|-----|-------------|--------------------------------|-----------------|----------|
| 1* | 50533101000 | Drive shaft assy. not=12 | | 1.00 |
| 2* | 50533105000 | Idler gear, 5th gear, teeth=21 | | 1.00 |
| 3* | 50533103000 | Sliding gear, 3rd/4th gear, te | | 1.00 |
| 4* | 50533102000 | Fixed gear, 2nd gear, teeth=15 | | 1.00 |
| 5* | 0405222611 | NEEDLE BEAR.K 22X26X10 DIVIDED | | 1.00 |
| 6* | 50533034000 | Thrust washer | | 1.00 |
| 7 | 50133090000 | LOCK RING 22X1,2 | | 1.00 |
| 8* | 50533033000 | Thrust washer | | 1.00 |
| 9 | 50333041000 | STOP DISC 17,2X26X1 B | | 1.00 |

| | | | | |
|-----|-------------|--------------------------------|--|------|
| 10 | 0625060041 | BALL BEARING 6004 TNH C3 | | 1.00 |
| 11 | 0625160031 | GROOVED BALL B. 16003 C4 J1 | | 1.00 |
| 12* | 50533106000 | Idler gear, 6th gear, teeth=20 | | 1.00 |
| 13* | 50533024000 | bushing | | 1.00 |

* = New part