

ACHTUNG !!!
Vor dem Einbau des Vergasers, Bedüsung kontrollieren.
CAUTION !!!
Before mounting the carburetor, check the jetting.

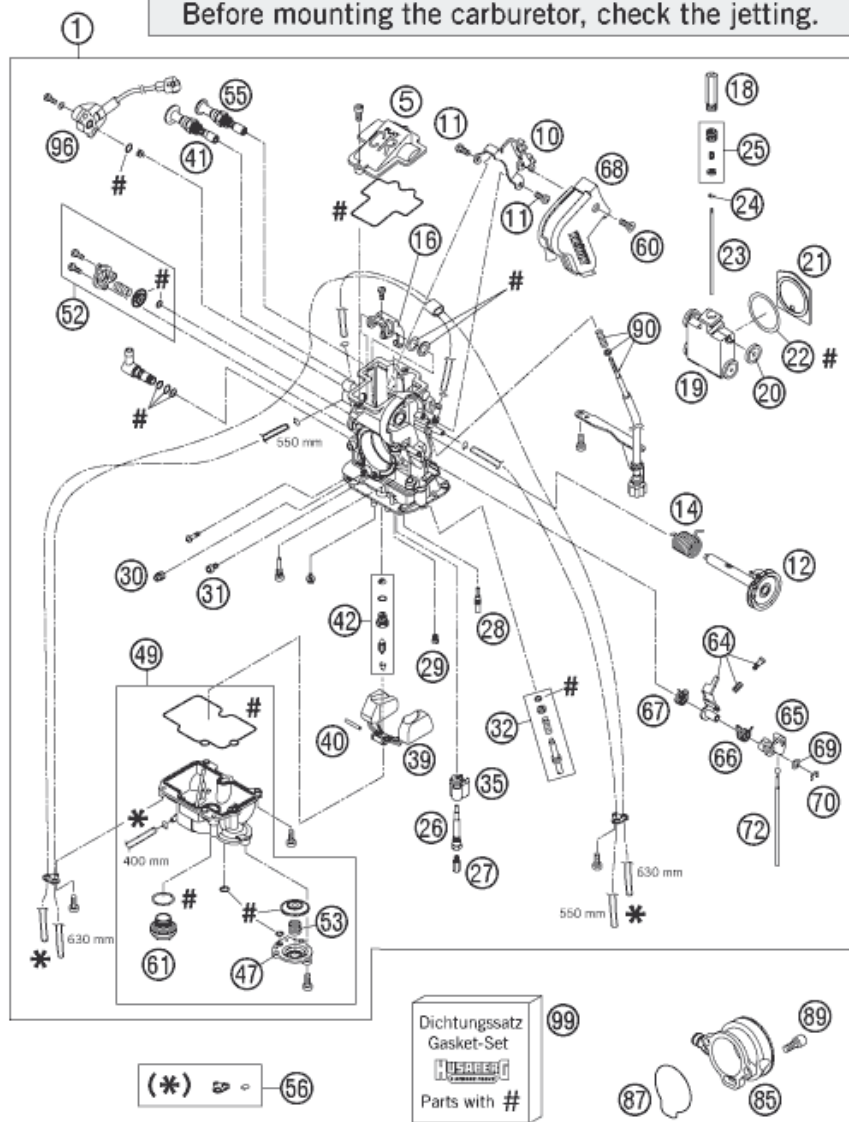

| Pos | Part Number | Description | Additional Text | Quantity |
|-----|-------------|-------------------------------|----------------------------|----------|
| 1* | 80031001300 | CARBURETOR KEIHIN FCR-MX39 05 | 450 FE | 1.00 |
| 1* | 80031001400 | CARBURETOR KEIHIN FCR-MX41 05 | 450/550 FC, 550 FE, 450 FS | 1.00 |
| 1* | 80031001500 | CARBURETOR KEIHIN FCR-MX41 05 | 650 FE+FS | 1.00 |
| 5 | 57331027000 | CARBURETOR COVER 2002 | | 1.00 |
| 10 | 57331080000 | BRACKET PLATE FOR THR. CABLE | | 1.00 |
| 11 | 57331055000 | SCREW M 5 X 8 | | 2.00 |
| 12 | 57331046000 | THROTTLE SHAFT CPL. | | 1.00 |
| 14 | 57331046050 | COIL SPRING THROTTLE SHAFT | | 1.00 |
| 16 | 57331035051 | LINK ARM THROTTLE VALVE CPL. | | 1.00 |
| 18 | 59031029006 | SLIDE STOP L=44MM 04 | 450-650 FE+FS (EU+AUS) | 1.00 |
| 19 | 57331035000 | THROTTLE VALVE CPL. | | 1.00 |

| | | | | |
|-----|-------------|--------------------------------|------------------------------|------|
| 20 | 59031035050 | BUSHING THROTTLE VALVE | | 4.00 |
| 21* | 57331035153 | GASKET PLATE THROTTLE VALVE 04 | | 1.00 |
| 22 | 59031035052 | GASKET WASHER THROTTLE VALVE | | 1.00 |
| 23 | 59031023200 | JET NEEDLE KEIHIN OBDVT | 525 MXC, EXC | 1.00 |
| 23 | 590310340VR | JET NEEDLE KEIHIN OBDVR | 450 MXC, EXC | 1.00 |
| 23 | 57331034300 | JET NEEDLE KEIHIN OBEKR | | 0.00 |
| 24 | 59031029000 | BAR CLIP | | 1.00 |
| 25 | 57331032000 | NEEDLE SET SCREW CPL. | | 1.00 |
| 26 | 59031121000 | NEEDLE JET FCR-MX | | 1.00 |
| 27 | 54531623160 | MAIN JET 160 KEIHIN | MXC, EXC | 1.00 |
| 27 | 54531623162 | MAIN JET 162 KEIHIN | | 0.00 |
| 27 | 54531623165 | MAIN JET 165 KEIHIN | SX | 0.00 |
| 27 | 54531623168 | MAIN JET 168 KEIHIN | SX | 0.00 |
| 27 | 54531623170 | MAIN JET 170 KEIHIN | | 0.00 |
| 27 | 54531623172 | MAIN JET 172 KEIHIN | | 0.00 |
| 27 | 54531623175 | MAIN JET 175 KEIHIN | 250 EXC EU+AUS, 300 MXC, EXC | 0.00 |
| 27 | 54531623178 | MAIN JET 178 KEIHIN | 200 MXC/EXC-USA | 1.00 |
| 27 | 54531623180 | MAIN JET 180 KEIHIN | 200 EXC-EU/AUS | 0.00 |
| 27 | 54531623182 | MAIN JET 182 KEIHIN | 250 EXC USA | 1.00 |
| 27 | 54531623185 | MAIN JET 185 KEIHIN | 125 SX | 0.00 |
| 27 | 54531623188 | MAIN JET 188 KEIHIN | 125/200 SX | 0.00 |
| 27 | 54531623190 | MAIN JET 190 KEIHIN | 200 SX | 0.00 |
| 28 | 54531607038 | IDLE JET 38 KEIHIN | 450-650 FE+FS | 1.00 |
| 28 | 54531607040 | IDLE JET 40 KEIHIN | 450 SMR | 1.00 |
| 28 | 54531607042 | IDLE JET 42 KEIHIN | 525 SMR | 0.00 |
| 28 | 54531607045 | IDLE JET 45 KEIHIN | 200 MXC/EXC-USA | 0.00 |
| 29 | 59031051085 | STARTER JET 85 | | 1.00 |
| 30 | 57331007100 | IDLE AIR JET 100 KEIHIN | | 1.00 |
| 31 | 57331037200 | MAIN AIR JET 200 KEIHIN | | 1.00 |
| 32 | 59031017100 | ADJUST SCREW CPL. FCR-MX | | 1.00 |
| 35 | 57331085000 | BUFFER PLATE | | 1.00 |
| 39 | 57331009000 | FLOAT CPL. | | 1.00 |
| 40 | 57331008000 | ARM PIN FLOAT | | 1.00 |
| 41 | 57331075000 | HOT-STARTER VALVE CPL. | | 1.00 |
| 42 | 57331020000 | NEEDLE VALVE CPL. | | 1.00 |
| 47 | 57331060000 | COVER ACCELERATOR PUMP | | 1.00 |
| 49 | 80031011044 | FLOAT CHAMBER CPL. SET 04 | | 1.00 |
| 52 | 57331090000 | AIR CUT VALVE 2002 | ONLY FOR 650 FE+FS | 1.00 |
| 53 | 59031059000 | COIL SPRING | | 1.00 |
| 55 | 57331048000 | STARTER VALVE CPL. | | 1.00 |
| 56 | 80031098000 | BREATH.HOSE FCR-MX KEIHIN CPL. | | 1.00 |
| 60 | 0965050103 | FLAT HEAD SCREW DIN0965-M 5X10 | | 1.00 |
| 61 | 57331014000 | HOLDING BOLT | | 1.00 |
| 64 | 57331062000 | INTERMEDIATE LEVER CPL. | | 1.00 |
| 65 | 57331056000 | LINK LEVER | | 1.00 |
| 66 | 57331059000 | SPRING LINK LEVER | | 1.00 |
| 67 | 57331159000 | SPRING INTERMEDIATE LEVER | | 1.00 |
| 68 | 57331038000 | CARBURETOR COVER | | 1.00 |
| 69 | 57331087000 | WASHER LINK LEVER | | 1.00 |
| 70 | 57331084000 | E-CLIP | | 1.00 |

| | | | | |
|-----|-------------|-----------------------------|----------------|------|
| 72 | 57331061000 | ROD ACCELERATOR PUMP | | 1.00 |
| 85 | 59031040200 | INTAKE FUNNEL FCR/FCR-MX 02 | SIDEWARDS OPEN | 1.00 |
| 87 | 59031040010 | O-RING FOR INTAKE FUNNEL | | 1.00 |
| 89 | 0912050123 | AH SCREW DIN0912-M 5X12 | | 2.00 |
| 90 | 80031025000 | STOP SCREW CPL. FCR-MX 04 | | 1.00 |
| 96* | 57331077000 | TPS-SENSOR FCRMX 140MM 2002 | | 1.00 |
| 99 | 57331099000 | GASKET SET FCR-MX KEIHIN | | 1.00 |

* = New part