

ACHTUNG !!!
Bei Bestellung von Getrieberädern, Markierung beachten.

CAUTION !!!
When ordering transmission gears, check marking.

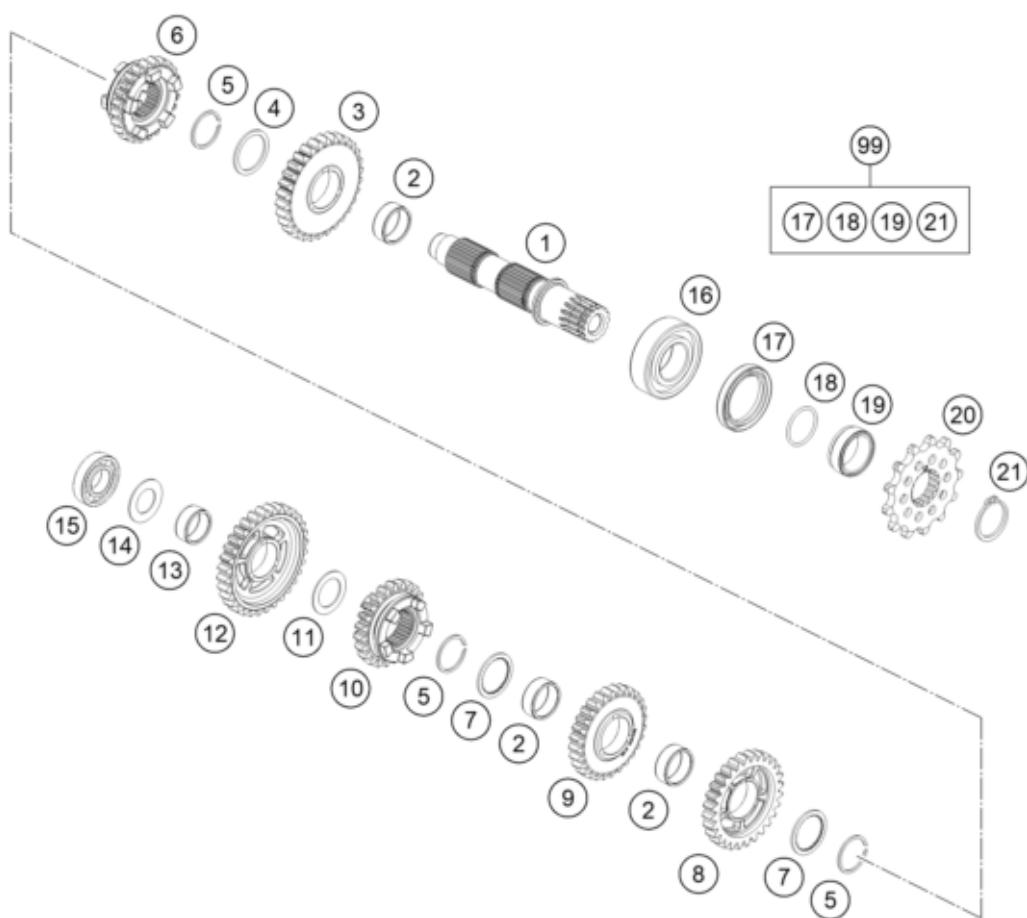

| Pos | Part Number | Description | Additional Text | Quantity |
|-----|-------------|--------------------------------|-----------------|----------|
| 1 | 50433010000 | DRIVEN SHAFT CPL. | | 1.00 |
| 2 | 0405222611 | NEEDLE BEAR.K 22X26X10 DIVIDED | | 3.00 |
| 3 | 50433112000 | IDLER 2ND GEAR NOT=31 | | 1.00 |
| 4 | 54833044000 | STOP DISC 25X31X1,5 | | 1.00 |
| 5 | 0417024000 | CIRCLIP WS24 | | 3.00 |
| 6 | 50433116000 | IDLER 6TH GEAR NOT=20 | | 1.00 |
| 7 | 54833043000 | STOP DISC 25X0,8X30X30X7H | | 2.00 |
| 8 | 50433113000 | Idler gear 3rd gear 28t | | 1.00 |
| 9 | 50433114000 | IDLER 4TH GEAR NOT=26 | | 1.00 |
| 10 | 50433115100 | IDLER 5TH GEAR NOT=25 | | 1.00 |
| 11 | 54833080000 | STOP DISC 20,2X30X1 | | 1.00 |

| | | | | |
|----|-------------|--------------------------------|--|------|
| 12 | 50433111000 | IDLER 1ST GEAR NOT=33 | | 1.00 |
| 13 | 0405202410 | NEEDLE BEARING K20X24X10 | | 1.00 |
| 14 | 56033030000 | STOP DISC 17,2X30X1 | | 1.00 |
| 15 | 0625160031 | GROOVED BALL B. 16003 C4 J1 | | 1.00 |
| 16 | 0625062054 | BALL BEARING 6205 C3 NTN | | 1.00 |
| 17 | 0760324571 | SHAFT SEAL RING 32X45X7 BSLNBR | | 1.00 |
| 18 | 0770230020 | O-RING 23,00X2,00 NBR70 | | 1.00 |
| 19 | 50433030000 | SPACER BUSHING 12,4 MM | | 1.00 |
| 20 | 79233029013 | Sprocket 13-t | | 1.00 |
| 21 | 0471250200 | CIRCLIP DIN0471 - 25X2 | | 1.00 |
| 99 | 00050000949 | COUNTER SHAFT REP. KIT 125 SX | | 0.00 |