

# ENTHALTEN IM DICHTSATZ MOTOR LC4  
INCLUDED IN GASKET-SET ENGINE LC4

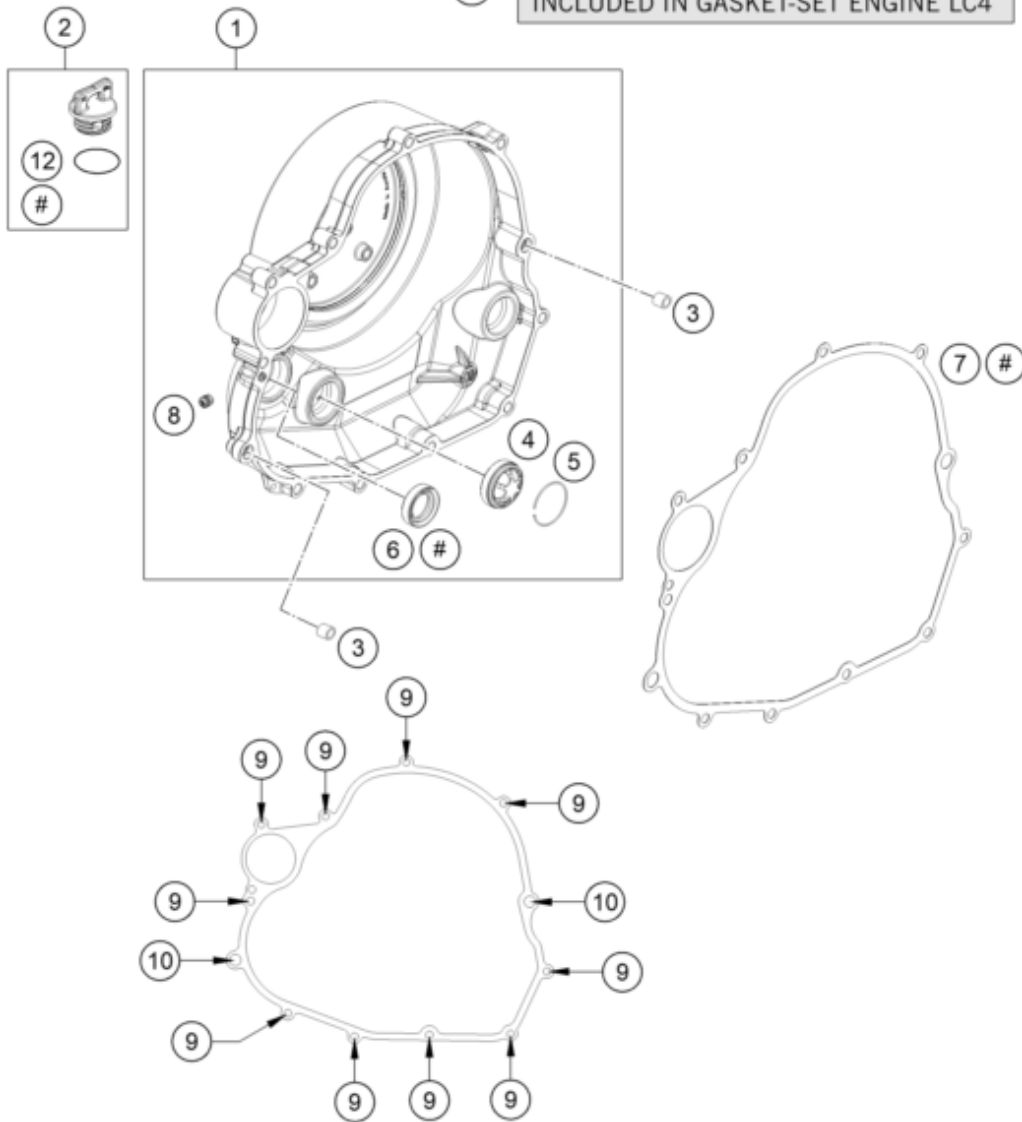

| Pos | Part Number   | Description                    | Additional Text | Quantity |
|-----|---------------|--------------------------------|-----------------|----------|
| 1   | 75030601044KA | CLUTCH COVER CPL.              |                 | 1.00     |
| 2   | 58030020100   | oil plug cpl. M24x3            |                 | 1.00     |
| 3   | 49030090000   | DOWEL 9,8 X 7 X 10             | FS-E            | 2.00     |
| 4   | 59030019200   | OIL SIGHT GLASS                |                 | 1.00     |
| 5   | 61030019050   | CIRCLIP OIL LEVEL GLASS 03     |                 | 1.00     |
| 6   | 0760172871    | SHAFT SEAL RING 17X28X7B VITON |                 | 1.00     |
| 7   | 75030025000   | CLUTCH CASE GASKET 07          |                 | 1.00     |
| 8   | 59030296000   | SCREW PLUG                     |                 | 1.00     |
| 9   | 0025060256    | HH collar screw M6x25 TX30     |                 | 9.00     |
| 10  | 0025060306    | HH collar screw M6x30 TX30     |                 | 2.00     |
| 12  | 0770191015    | O-RING 19,00X3,00 NBR          |                 | 1.00     |